

DYZ-011 柱式传感器 Column sensor

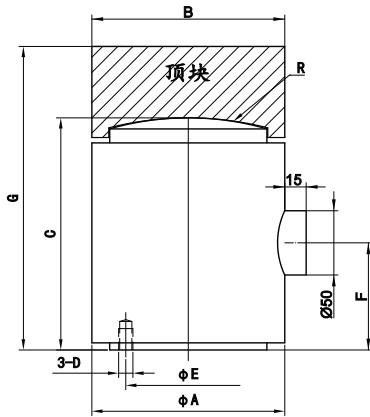

外形尺寸 External Dimension



量程 (T)	2-20	30-50	60-100	200	300	500	700-1000t
Φa	54	78	98	128	154	196	246
ΦB	54	78	98	128	154	196	246
C	65	100	110	140	170	220	282
D	M4	M6	M6	M6	M8	M10	M16
E	35	55	75	100	120	150	190
R	80	100	120	200	300	400	500
G	85	125	140	180	215	275	352
F	30	47	55	70	85	110	132

产品综述 Product Reviews

特性:

结构紧凑, 综合精度高, 长期稳定性好, 优质合金钢表面镀镍。

应用领域:

大力值试验机、标准测力仪、压力测试仪器以及自动化设备领域和测试领域。

Characteristic:

Compact structure, high comprehensive precision, good long-term stability, high quality alloy steel surface nickel plating.

Application fields:

The field of large value testing machine, standard dynamometer, pressure testing instrument, automation equipment and testing field.



传感器接线示意图 Sensor wiring diagram

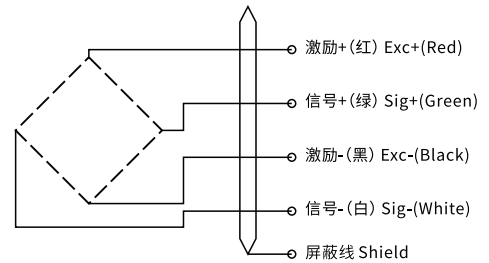

传感器受力图 Force diagram of sensor

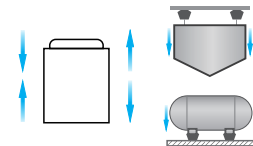

参数表 Parameters Table

量程 Capacity	0-1000T	材质 Material	合金钢
输出灵敏度 Rated Output	2.0/3.0±10%mv/V	阻抗 Impedance	700Ω
零点输出 Zero Balance	±2%F.S.	绝缘电阻 Insulation	≥5000MΩ/100VDC
非线性 Non-Linearity	0.3%F.S.	使用电压 working voltage	5-15V
滞后 Hysteresis	0.1%F.S.	工作温度范围 Operating Temp Range	-20-80°C
重复性 Repeatability	0.1%F.S.	安全过载 Safe Overload	150%
蠕变(30分钟) Creep(30min)	0.05%F.S.	极限过载 Maximum Overload	200%
温度灵敏度漂移 Temp Effect on Output	0.05%F.S./10°C	电缆线规格 Cable Specifications	φ5x3m
零点温度漂移 Temp Effect on Zero	0.05%F.S./10°C	线缆极限拉力 Cable ultimate pull	10kg
响应频率 Response frequency	10kHz	TEDS 可选	