

外形尺寸 External Dimension

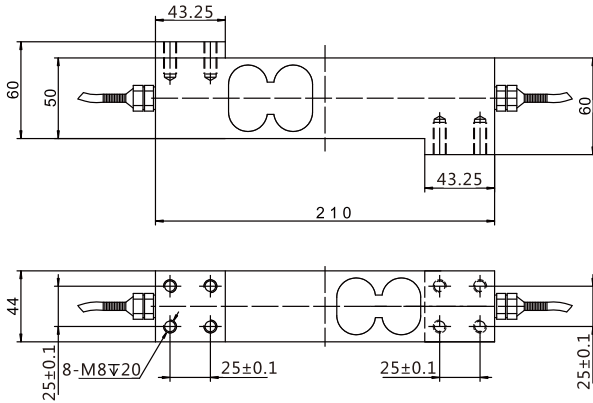

受力方向量程(kg)

X	50	100	200	500	1000
Y	50	100	200	500	1000

产品综述 Product Reviews

特性:

拉压双向受力、结构紧凑、综合精度高、长期稳定性好、优质合金钢表面镀镍。

应用领域:

应用于机器人打磨, 焊接, 装配等关节力检测, 机器人触觉力示教, 疲劳试验机, 汽车耐久试验, 假人碰撞实验等

Characteristic:

It has the advantages of bi-directional tension and compression, compact structure, high comprehensive precision, good long-term stability and nickel plating on the surface of high-quality alloy steel.

Application fields:

It is used in robot grinding, welding, assembly and other joint force detection, robot tactile force teaching, fatigue testing machine, automobile durability test, dummy collision test, etc.

传感器接线示意图 Sensor wiring diagram

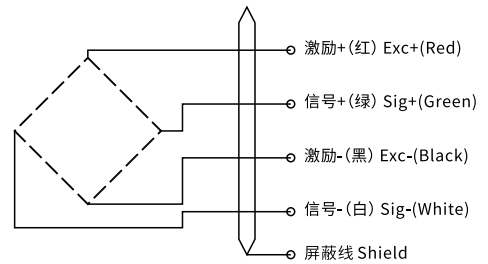

传感器受力图 Force diagram of sensor

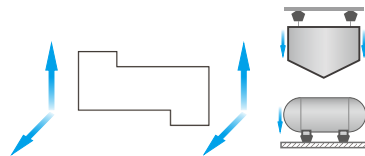

参数表 Parameters Table

量程 Capacity	0-1000kg	材质 Material	合金钢
输出灵敏度 Rated Output	1.0mV/V	阻抗 Impedance	350Ω
零点输出 Zero Balance	±2%F.S.	绝缘电阻 Insulation	≥5000MΩ/100VDC
非线性 Non-Linearity	0.1%F.S.	使用电压 Operating Temp Range	5-15v
滞后 Hysteresis	0.1%F.S.	工作温度范围 Operating Temp Range	-20-75°C
重复性 Repeatability	0.1%F.S.	安全过载 Safe Overload	150%
蠕变(30分钟) Creep(30min)	0.1%F.S.	极限过载 Maximum Overload	300%
温度灵敏度漂移 Temp Effect on Output	0.5%F.S./10°C	电缆线规格 Cable Specifications	φ5x4m
零点温度漂移 Temp Effect on Zero	0.05%F.S./10°C	线缆极限拉力 Cable ultimate pull	10kg
响应频率 Response frequency	10kHz	TEDS可选	